

# JS

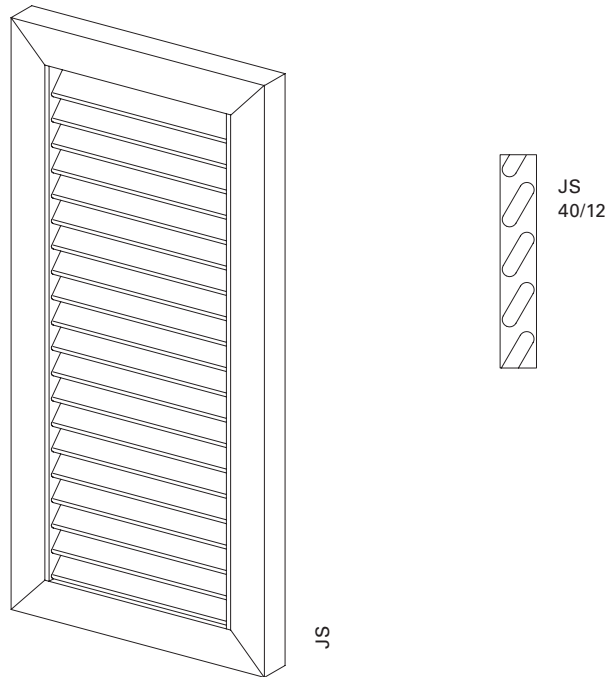

---

<b>Surface</b>	Fine structure matt (standard), silk gloss, matt Powder-coated 200°C before assembly
<b>Colours</b>	RAL Classic, RAL Design, NCS, VSR
<b>Finishes</b>	Wood, stone, rust
<b>Pretreatment</b>	Ocean Line Plus possible
<b>Notes</b>	Electric drive and finish are not possible in combination with special shapes Drain holes at bottom of frame Slats are exchangeable Floor locking in combination with special shapes can only be installed to a limited extent



Slat profile

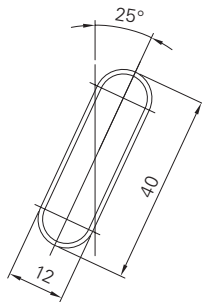

JS

Frame profile

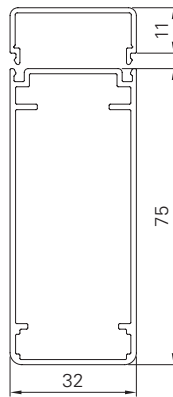

R75

<b>Min./Max. dimensions</b>	Width: 280 to 800 mm Height: 800 to 2500 mm
<b>Min./max. infeed</b>	33,0–36,7 mm
<b>Inclination angle</b>	25°
<b>Weight</b>	Approx. 6 kg/m <sup>2</sup>
<b>Frame profile</b>	75 × 32 mm extruded aluminium hollow chamber profile
<b>Slat profile</b>	40 × 12 mm extruded aluminium hollow chamber profile
<b>Slat carrier profile</b>	32 × 11 mm extruded aluminium
<b>Stop bead</b>	Supplied loose, black or white rubber (depending on sash colour)
<b>Corner connections</b>	Aluminium bracket, glued-in and additionally secured by plastic pins
<b>Options</b>	Notching   Add-on lock   Opener   Floor locking   Easyflex   Electric drive   Rabbit bead   Vertical cross-panel   Half-round arch (mounted)   Horizontal cross-panel   Inside opener crank   Rod lock   Basic frame   Pre-installation   Segmental arch, hollow (mounted)   Catch   Segmental arch, solid (mounted)   Frames   Special shapes (arched frame profile)