

# PLANO-MAX28

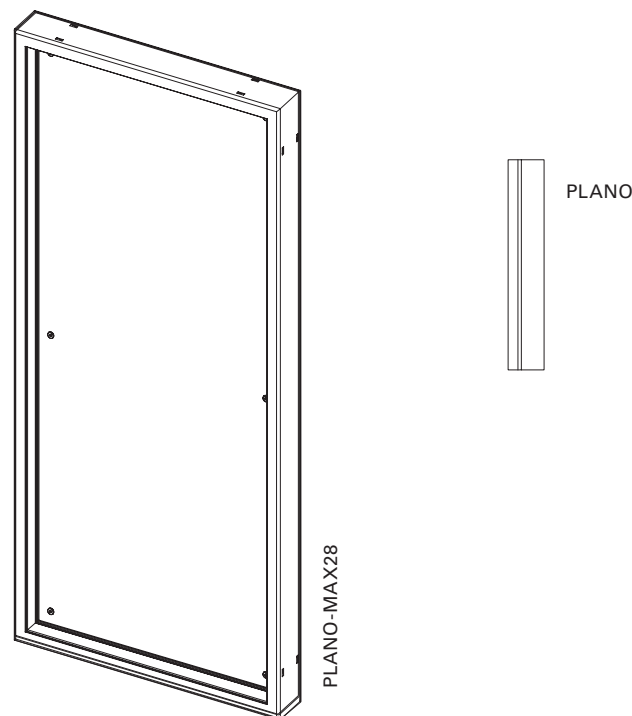

Surface	Fine structure matt (standard), silk gloss, matt Powder-coated 200 °C before assembly
Colours	RAL Classic, RAL Design, NCS, VSR
Finishes	Wood, stone, rust
Pretreatment	Ocean Line Plus possible
Notes	Drain holes at bottom of frame



Frame profile

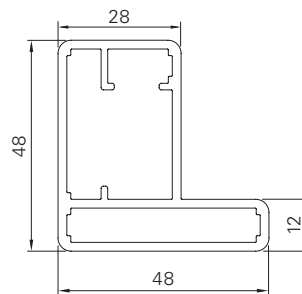

MAX28

Min./Max. dimensions	Width: 550 to 1500 mm Height: 800 to 3000 mm
Weight	Approx. 10 kg/m <sup>2</sup>
Frame profile	48 × 48 mm extruded aluminium hollow chamber profile, visible frame width 12 mm
Centre	One-sided riveted in frame, 2 mm aluminium plate
Corner connections	Glued-in aluminium bracket with visible notch in the outer frame
Options	Electric drive