

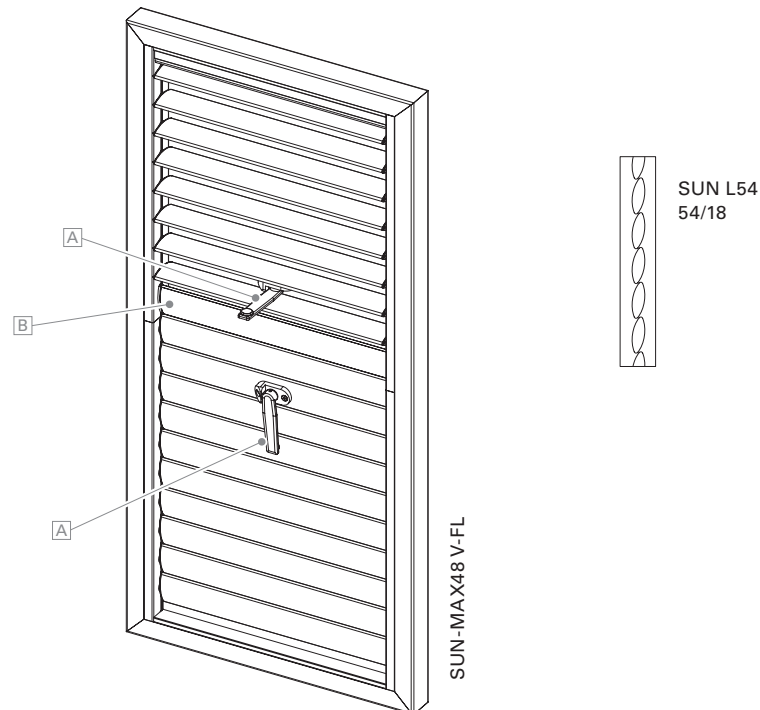

SUN-MAX48 V-FL



Surface	Fine structure matt (standard), silk gloss, matt Powder-coated 200 °C before assembly
Colours	RAL Classic, RAL Design, NCS, VSR
Finishes	Wood, stone, rust
Pretreatment	Ocean Line Plus possible
Adjustment lever 	Flexible operating height (as option); Horizontal position: in the middle at sash width <1000 mm, offset to the left/right side depending on the stop diagram at a distance of 170 mm from the outer edge of the frame at sash width ≥1000 mm; Angle of opening adjustable in four different indexed positions
Notes	Drain holes at bottom of frame Slat end caps made of black or white plastic Additional adjustable slat field separated by screw channel slat  fixed as a horizontal cross-panel



Centre

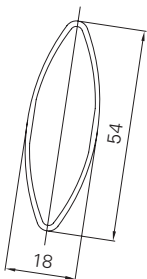

SUN L54

Frame profile

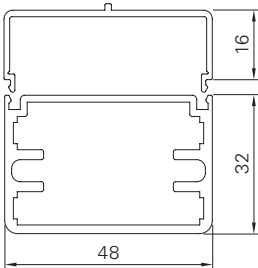

MAX48

Profili di compensazione

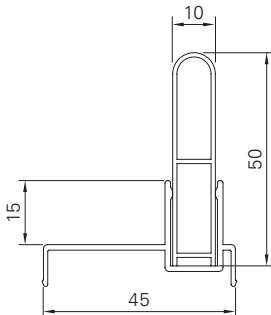

VAN48 / VAL48

Min./max. dimensions	Width: 650 to 1500 mm Height: 800 to 3000 mm
Infeed	50,0 mm
Min./max. inclination angle	4–89°
Weight	Approx. 13 kg/m²
Frame profile	48 × 32 mm extruded aluminium hollow chamber profile
Slat profile	54 × 18 mm extruded aluminium hollow chamber profile
Horizontal cross-panel	54 × 18 mm extruded aluminium hollow chamber profile (screw channel slat)
Slat carrier profile	48 × 16 mm extruded aluminium profile
Adjustment profiles	45 × 15 mm and 10 × 50 mm extruded aluminium profile (at top and bottom)
Corner connections	Glued-in aluminium bracket with visible notch in the outer frame
Options	Electric drive Sliding shutter flush bolt