

## Protection against intruders

Greater security with aluminium window shutters



## Tested safety



### Effective combinations make the difference

To stop burglars in their tracks, it's important to ensure the perfect combination of model, frame, straps and special fittings. If installed correctly, this produces reliable solutions, which are adapted to individual risk situations.

The TSW-S and TIZO-S models of the EHRET security frame even satisfy the requirements of resistance class RC2.

### Resistance classes in accordance with EN 1627 (RC2)

The intrusion protection standard is split into resistance classes or RC for short. For residential properties, the police recommend the RC2 class to protect against break-ins.

Products of this class are designed to have no weak spots in their overall construction (frame, fitting and centre), and are tested accordingly. Resistance class RC2 provides resistance for at least three minutes if opportunists with simple tools attempt to break in.

Relax and enjoy your home



Most people consider their own four walls to be a place of safety and security. Here they feel at home and recharge their batteries. But that sense of security can quickly disappear. One break-in is all it takes and they lose confidence in their security. It's not just the material damage experienced, but also and most importantly the invasion of privacy. But you can take steps to effectively prevent this and feel safe and secure in your home.

#### Our extensive protection against intruders for your home

To satisfy the growing intrusion protection requirements of residents and insurance companies, EHRET has developed reliable security solutions for window shutters.

Various forms of security elements on windows and balcony doors offer effective protection against intruders and ensure that shutters can only be pried off or unhinged with great effort.



# Measures to enhance security against break-ins

## Window shutter models

If you decide to invest in EHRET window shutters featuring a closed insert, you are benefiting from the number-one choice in enhanced security. The type

of insert – smooth or with slats – influences the protection against intruders. Aluminium shutters with closed inserts (closed models) therefore afford intruders hardly any opportunity for breaking in.



## Fittings and other options for added security

Various security elements reduce scope for break-ins and mean that it is harder to unhinge or break open window shutters without a lot of effort. Using security catches to provide protection against unhinging and the locking ring for the express hinge increase security – regardless of whether the sash is hung in the reveal or not.

Burg rods and rod locks installed on the interior of the window shutter offer yet more protection against intruders. The effective additional locking mechanisms can be operated easily once the window shutters have been closed.

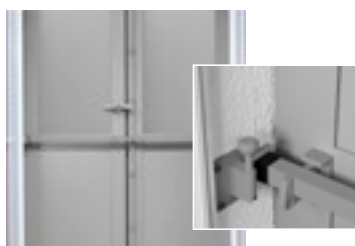

Burg rod



Rod lock (surface-mounted)



Rod lock (installed)



Security catch



Express hinge with locking ring



Slide and central closure

### EHRET protection against intruders is DIN-tested

The specially developed security frame has been designed to match EHRET window shutters. It offers extra security as well as a level of protection that meets the criteria of resistance class RC2.

The frame, which is welded on all four sides, and the TSW-S and TIZO-S reinforced window shutter

models have been tested in accordance with EN1627 by the ift Rosenheim testing institute and have RC2 certification.

The EHRET security frame is delivered completely preinstalled and with the required model. When mounting, ensure that the substrate is suitable for the installation.



Certified by ift Rosenheim:  
RC2 in accordance with the  
EN 1627 standards

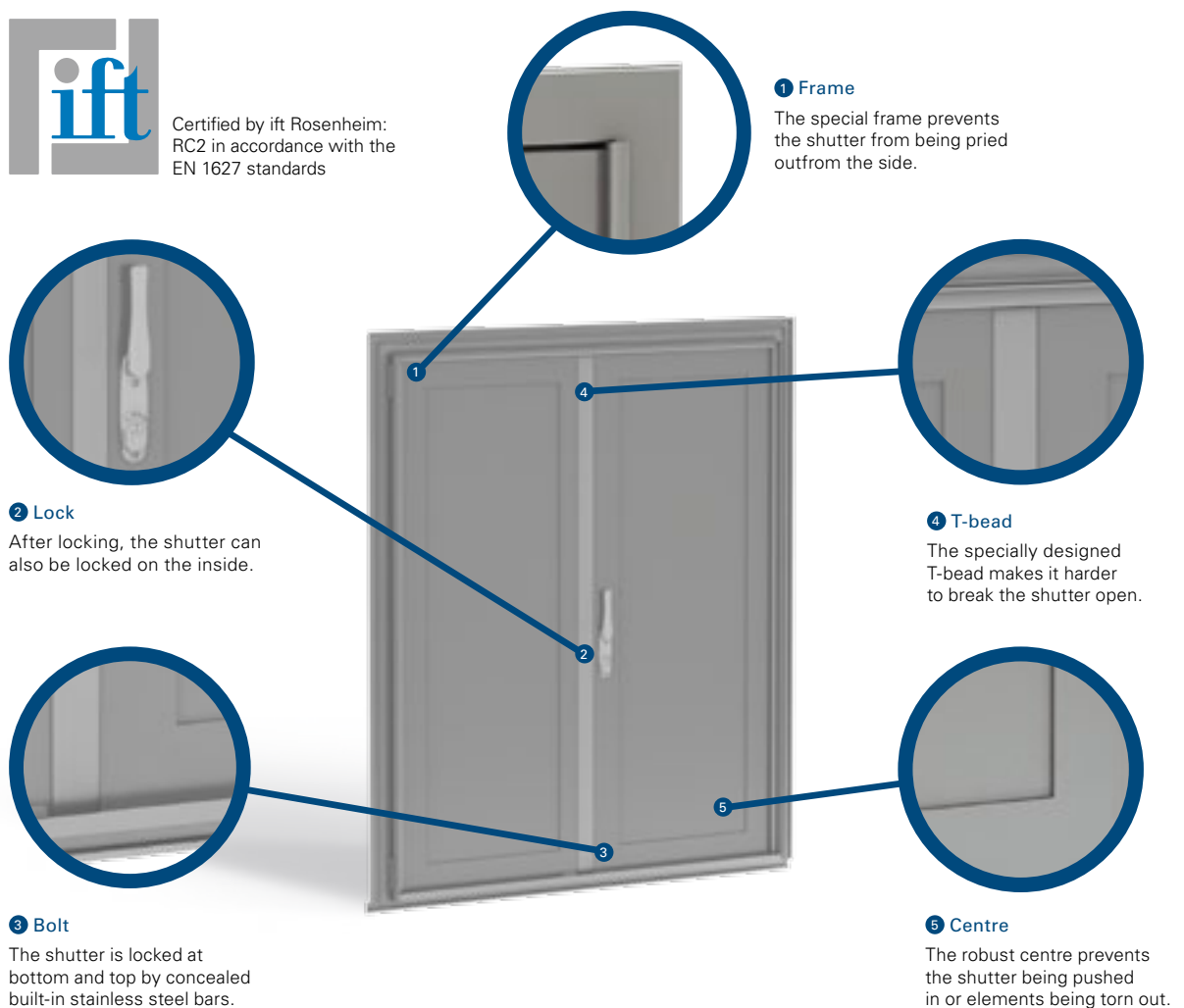

### Colours and decorative finishes

To give the frame and centre an individual character, you can pick from over 4000 different colours and decorative finishes. Standardised colour systems (RAL, NCS, VSR) allow the shutters to be colour-matched perfectly to other elements of the façade and vice versa.



EHRET GmbH  
Bahnhofstrasse 14-18  
77972 Mahlberg, Germany  
Tel. +49(0) 78 22/439-0  
Fax +49(0) 78 22/439-116  
[www.ehret.com](http://www.ehret.com)



■ ■ ■ Made in Germany

© 02.2016 EHRET GmbH | E | Subject to technical modifications